

料号 Part NO.	品名 Parts Name	型号 Part NO.	束线范围 $\varnothing A$	B	C	D	E	F	相关认证
38-AP-1720	二段式扎线固定座	AP-1720	16.5-20.1	42.0	37.0	25.0	3.0	12.7	

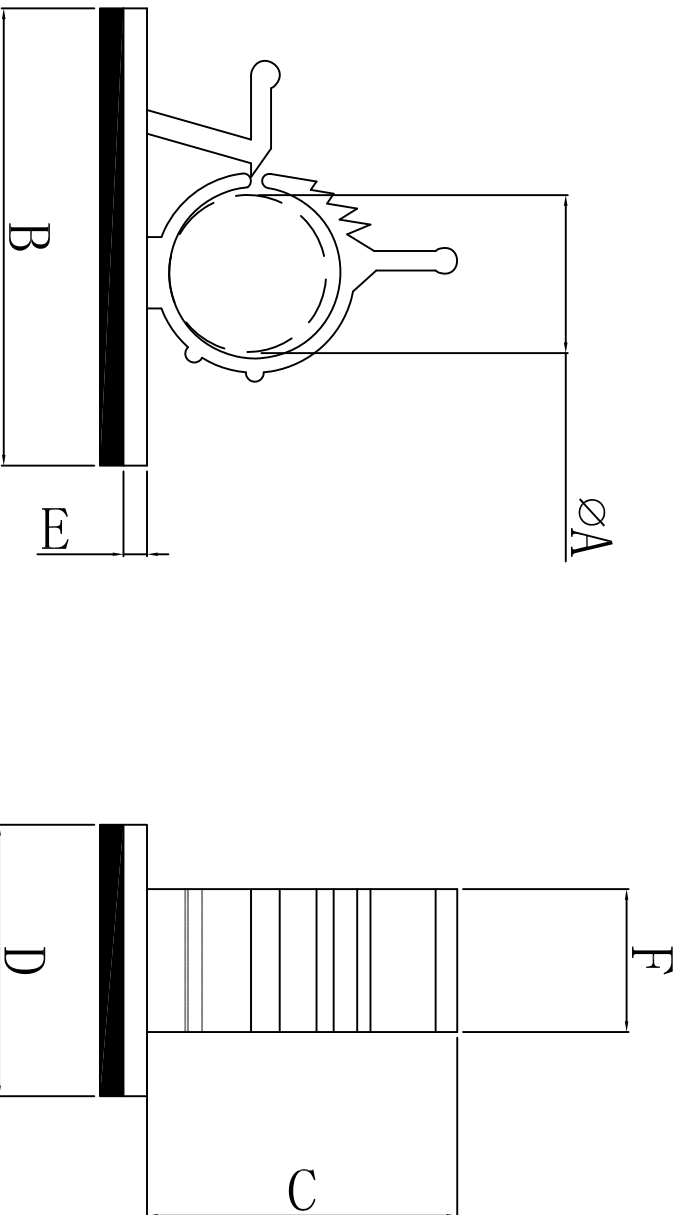

特点：撕开背胶可固定于平面上，再以束带穿入即可固定
材料：尼龙66，防火等级94V-2



未经授权不得修改和复印
该知识产权属于技术质量部

DIMENSION	TOLERANCES	FRIST ANGLE PROJ			
		A	NEW PART	DWG. BY	CHK. BY
0.0 0.00	±0.5	LTR.	REVISION RECORD	DATE	

DWG. BY	CHK. BY	APP. BY	DWG. NO.	UNIT	mm
lia liang	oulluan	wang zhiguan		REV.	A
DWG. BY	CHK. BY	APP. BY	DWG. NO.	UNIT	mm
oulluan	zy wang			REV.	A
DWG. BY	CHK. BY	APP. BY	DWG. NO.	UNIT	mm
oulluan	zy wang			REV.	A

DWG. BY	CHK. BY	APP. BY	DWG. NO.	UNIT	mm
lia liang	oulluan	wang zhiguan		REV.	A

DWG. BY	CHK. BY	APP. BY	DWG. NO.	UNIT	mm
lia liang	oulluan	wang zhiguan		REV.	A