

料号 material No.	品名 Parts Name	型号 Part NO.	接插规格 connecting spec	W	F	L	B	∅D	∅C	厚度
40-MDFN1.25-250	全绝缘接头	MDFN1.25-250	0.8*6.35	6.35	7.7	23.0	11.0	4.0	1.7	0.4

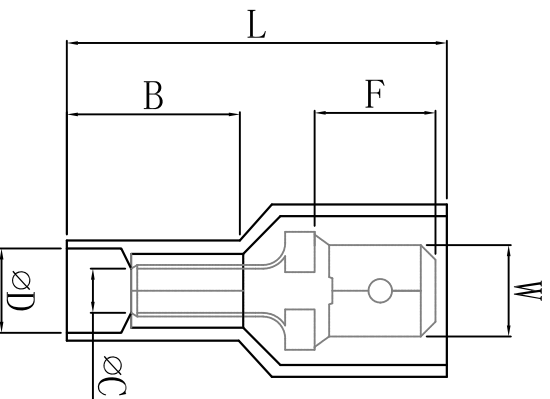

导线截面: 0.5-1.5mm² (美国线规22-16)
 最大电流: I_{max}=10A
 材 质: 黄铜
 绝缘套材料: 尼龙



DIMENSION	TOLERANCES					DWG. BY	CHK. BY	DATE	UNIT	mm
0.0 0.00	±0.5	A	NEW PART	<i>wallian</i>	<i>ya wang</i>	<i>2019/05</i>				
FIRST ANGLE PROJ		LTR.	REVISION RECORD	DWG. BY	CHK. BY	DATE	APP. BY	DWG. NO.	HIMA/QR-JZ-40-MDFN1.25-250	
							<i>wang zhiyan</i>		REV.	A

未经许可不得修改和复印
 该知识产权属于技术质量部