

料号 Part NO.	品名 Parts Name	型号 Part NO.	适用电线/wrie Range		Screw 螺丝	尺寸 Dimensions (mm/in.)						Packing 包装	相关认证
			Cross-Sec.	AWG, Cu		A	B	C	D	E	F		
41-12H	端子台(H型)	PA12	6mm <sup>2</sup>	#22-#10 Sol Str	M3.5 × 7	140.7	23.80	19.00	12.00	3.90	4.1 ± 0.2	40pcs/bag 400pcs/Ctn	VDE/CQC/UL/CSA

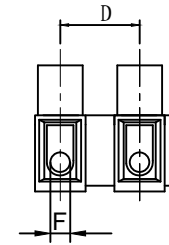
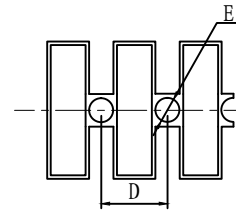
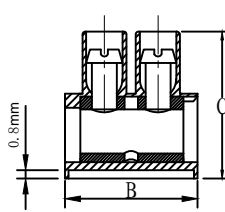
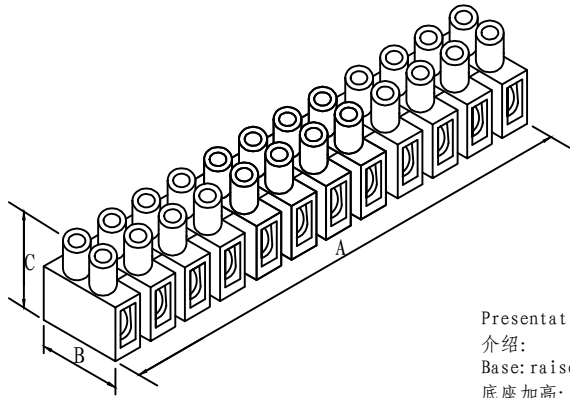

Presentation:

介绍:  
 Base: raised base: 0.8mm.  
 底座加高: 0.8mm  
 Housing material : PA66, 94V-2.  
 外观材质: 尼龙66, 阻燃等级94-V2.  
 Temperature: 105°C (UL), -30°C to T110°C.  
 温度: 105°C (UL), -30°C to T110°C .  
 Internal Material  
 : Brass, nickel-plated.  
 内部材质: 铜镀镍.  
 Screw: steel zinc-plated  
 螺丝: 铁镀锌.  
 Standard type: 12pcs.  
 标准端子数: 12pcs.

技术参数:

VDE/FI/CQC: 500V, 41A, 6.0mm<sup>2</sup>  
 UL/CSA: 300V, 35A, #22-#10



未经许可不得修改和复印  
 该知识产权属于技术质量部

DIMENSION	TOLERANCES						DWG. BY	<i>liu liang</i>	UNIT	mm
0.0 0.00	±1.0						CHK. BY	<i>sullivan</i>	REV.	A
							APP. BY	<i>wang zhiyan</i>	DWG. NO.	HIWA/QR-JZ-41-12HH
FRIST ANGLE PROJ		A	NEW PART	<i>sullivan</i>	<i>zy.wang</i>	<i>2010/02/08</i>	苏州惠华电子科技有限公司			
		LTR.	REVISION RECORD	DWG. BY	CHK. BY	DATE				